

OPEN CUT CROSSING - BARNUMS CHANNEL
PLAN VIEW
SCALE: 1" = 20'

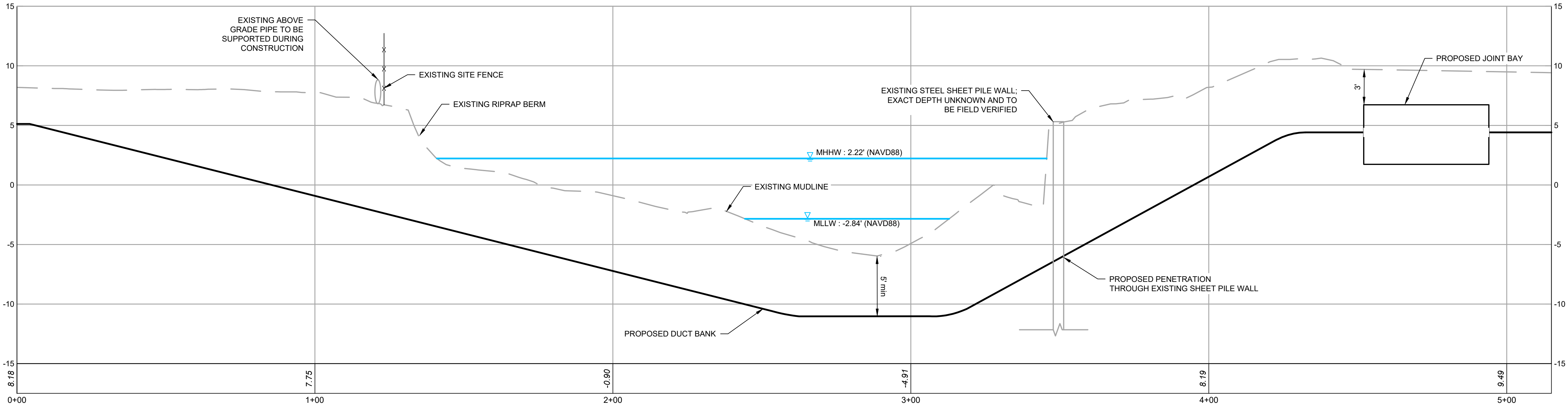

OPEN CUT CROSSING - BARNUMS CHANNEL
PROFILE VIEW
HORIZONTAL SCALE: 1" = 20'
VERTICAL SCALE: 1" = 5'

- NOTES:
1. LOCATION AND DEPTH OF ALL UTILITIES ARE TO BE FIELD VERIFIED.
 2. PROPOSED CABLE ALIGNMENTS SHOWN MAY BE ADJUSTED DUE TO UNFORESEEN CONDITIONS.
 3. MOTT MACDONALD HAS NOT CONDUCTED CIVIL SURVEYS WITHIN THE AREA SHOWN.
 4. THE SURVEYED CONTOURS (ONSHORE) AND IMAGERY SHOWN ARE FROM AN AERIAL FLIGHT FLOWN ON 04/23/2021 PROVIDED BY ROBINSON AERIAL.
 5. BATHYMETRIC DATA WITHIN BARNUMS CHANNEL IS FROM PUBLIC SOURCES (NOAA).
 6. HORIZONTAL DATUM IS NAD83, NEW YORK STATE PLANE, LONG ISLAND US FOOT. VERTICAL DATUM IS NAVD1988.
 7. CONVERSION FOR VERTICAL DATUM IS NAVD88 + 2.84' = MLLW.
 8. DRAWING IS FOR PERMITTING PURPOSES ONLY, NOT FOR CONSTRUCTION.

© Mott MacDonald
This document is issued for the party which commissioned it and for specific purposes connected with the captioned project only. It should not be relied upon by any other party or used for any other purpose. We accept no responsibility for the consequences of this document being relied upon by any other party, or being used for any other purpose, or containing any error or omission which is due to an error or omission in data supplied to us by other parties.

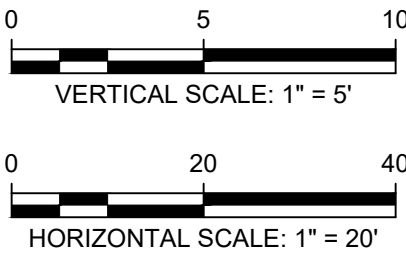

M

M

MOTT
MACDONALD

Mott MacDonald NY Inc.
1400 Broadway, 21st Floor
New York, NY 10018-0000
Certificate of Authorization #: 0017019

www.mottmacamericas.com

Client EMPIRE OFFSHORE WIND LLC.

B	04/07/2023	DOW	RE-ISSUED FOR ARTICLE VII APP. (2 CIRCUIT)	KEK	MDN	
A	01/28/2022	DOW	ISSUED FOR ARTICLE VII APPLICATION	KEK	MDN	
Rev	Date	Drawn	Description	Ch'k'd	App'd	

DRAFT

Date

Project Number

505100904

B/O

Total

Designed	MDN		Eng check	MDN	
Drawn	DOW		Coordination	KEK	
Dwg check	KEK		Approved	MDN	
Scale at ANSI D	Status	Rev	Security		
As Shown	PRE	B	STD		
Drawing Number OPEN CUT (BARNUMS CHANNEL)					

EMPIRE OFFSHORE WIND LLC.
EMPIRE WIND 2 PROJECT
OPEN CUT (BARNUMS CHANNEL) PLAN & PROFILE
NASSAU COUNTY, NEW YORK
ISSUED FOR ARTICLE VII APPLICATION

C:\P\WORKING\00591448\EW2_CROSSING_OPENCUT_BARNUMCHANNEL.DWG
SAVE DATE/TIME: 4/7/2023 3:52:41 PM

DRAFT – NOT FOR CONSTRUCTION



1. DIMENSIONS ARE APPROXIMATE AND SUBJECT TO CHANGE AS DESIGN IS FINALIZED.
2. SUBSTATION SITE MAY BE ELEVATED. MAX HEIGHT WILL NOT EXCEED 75 FT ABOVE EXISTING GRADE (INCLUDES ELEVATION AND STRUCTURES).
3. CABLE ROUTING SHOWN IS PRELIMINARY AND SUBJECT TO CHANGE AS DESIGN IS FINALIZED.

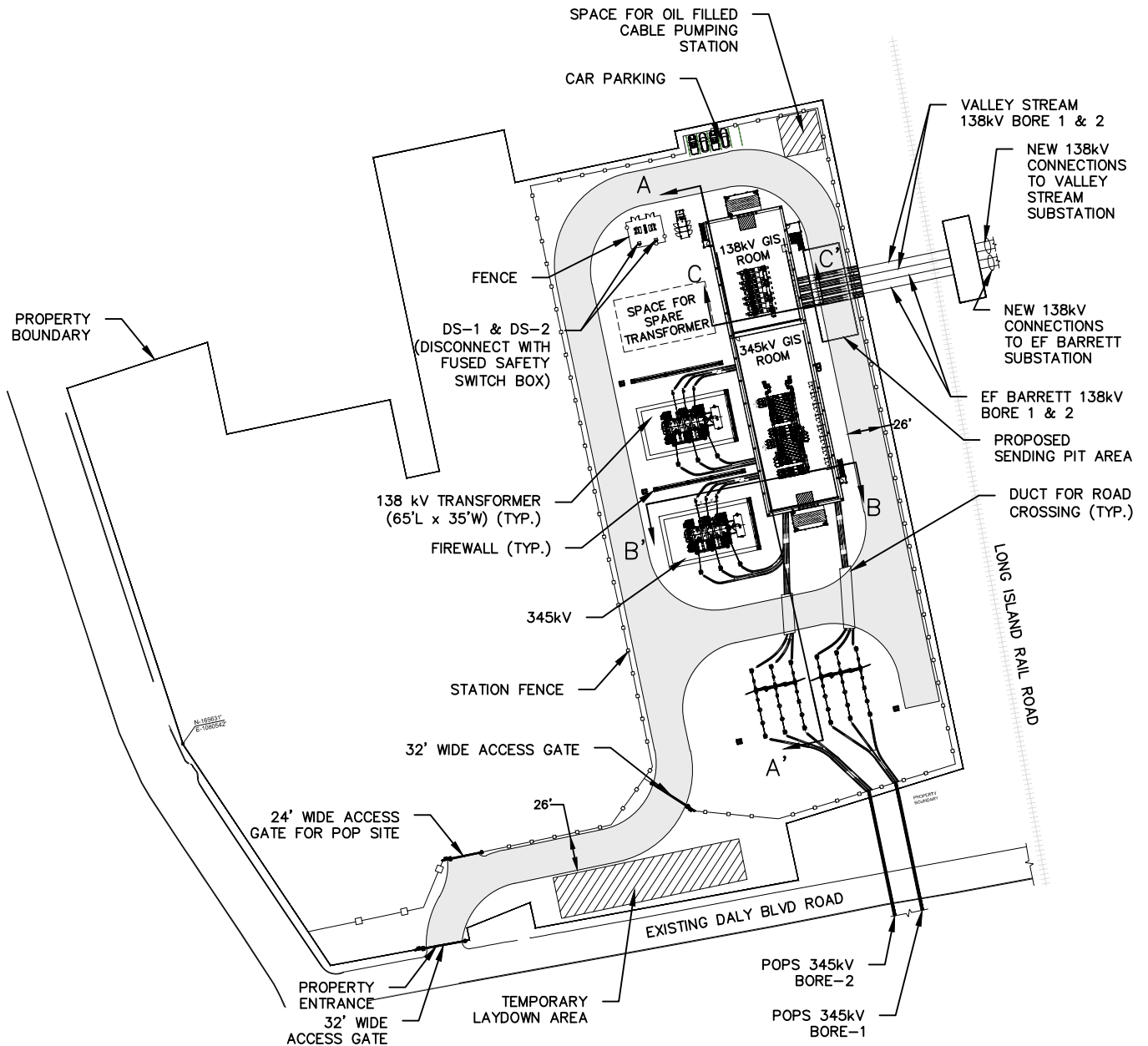

0 60 120
Feet
Scale: 1" = 120'



TETRA TECH

www.tetrattech.com

10 Post Office Square, 11th Floor
Boston, MA 02109
Phone: (617) 443-7500 Fax: (617) 737-3480

Empire Offshore Wind LLC and EW Offshore Wind Transport Corporation

Empire Wind 2 Project
Hampton Road Substation Layout

NOTE: DIMENSIONS ARE APPROXIMATE
AND SUBJECT TO CHANGE AS DESIGN IS
FINALIZED.

PROJ: 194-1247-0001

DATE: 06/29/2023

DESN: S. Goyette

Figure

3

DRAFT – NOT FOR CONSTRUCTION

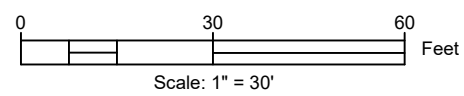
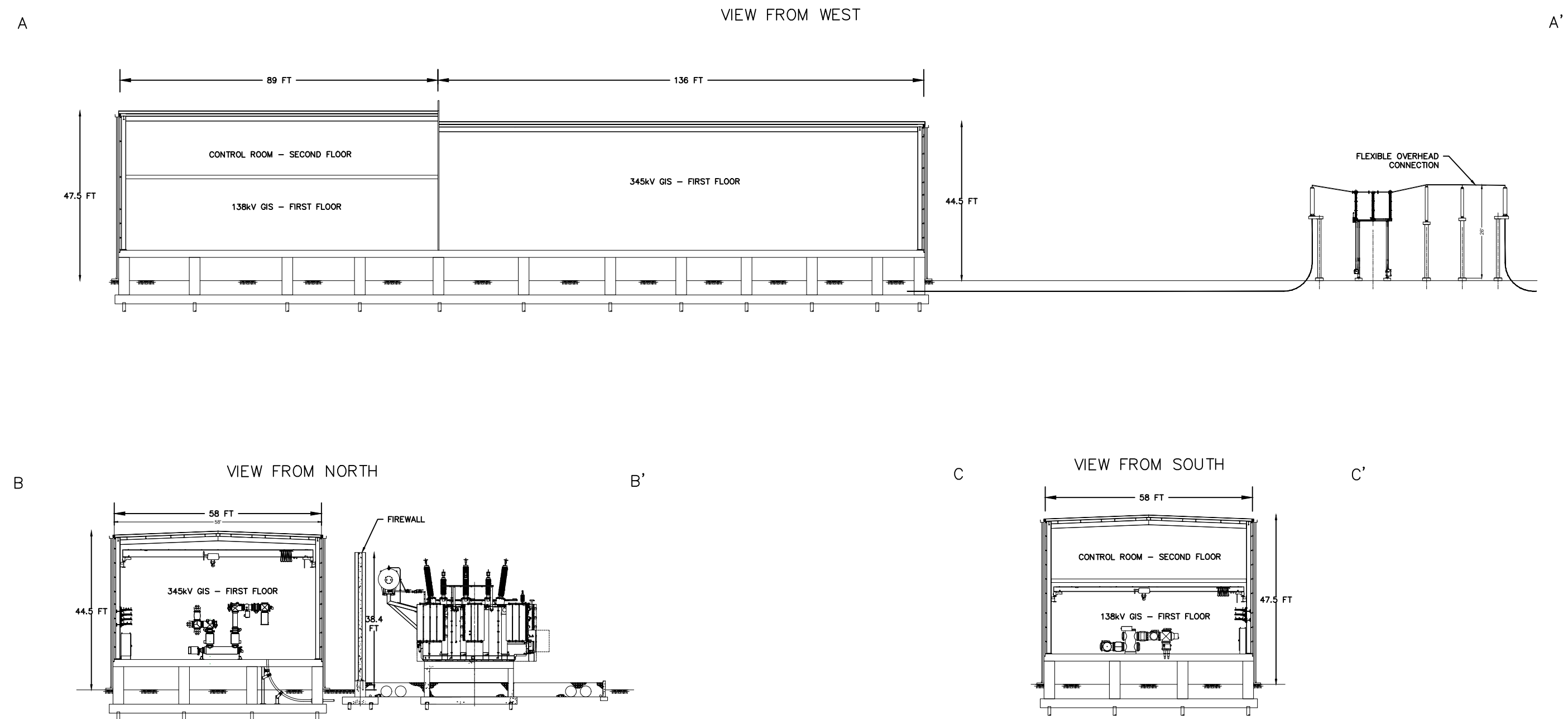

1. DIMENSIONS ARE APPROXIMATE AND SUBJECT TO CHANGE AS DESIGN IS FINALIZED.
2. SUBSTATION SITE MAY BE ELEVATED. MAX HEIGHT WILL NOT EXCEED 75 FT ABOVE EXISTING GRADE (INCLUDES ELEVATION AND STRUCTURES).

TETRA TECH
www.tetrattech.com
10 Post Office Square, 11th Floor
Boston, MA 02109
Phone: (617) 443-7500 Fax: (617) 737-3480

Empire Offshore Wind LLC and EW Offshore Wind Transport Corporation
Empire Wind 2 Project
Hampton Road Onshore Substation Layout

PROJ: 194-1247-0001
DATE: 06/29/2023
DESN: S. Goyette

Figure
4

Bar Measures 1 inch

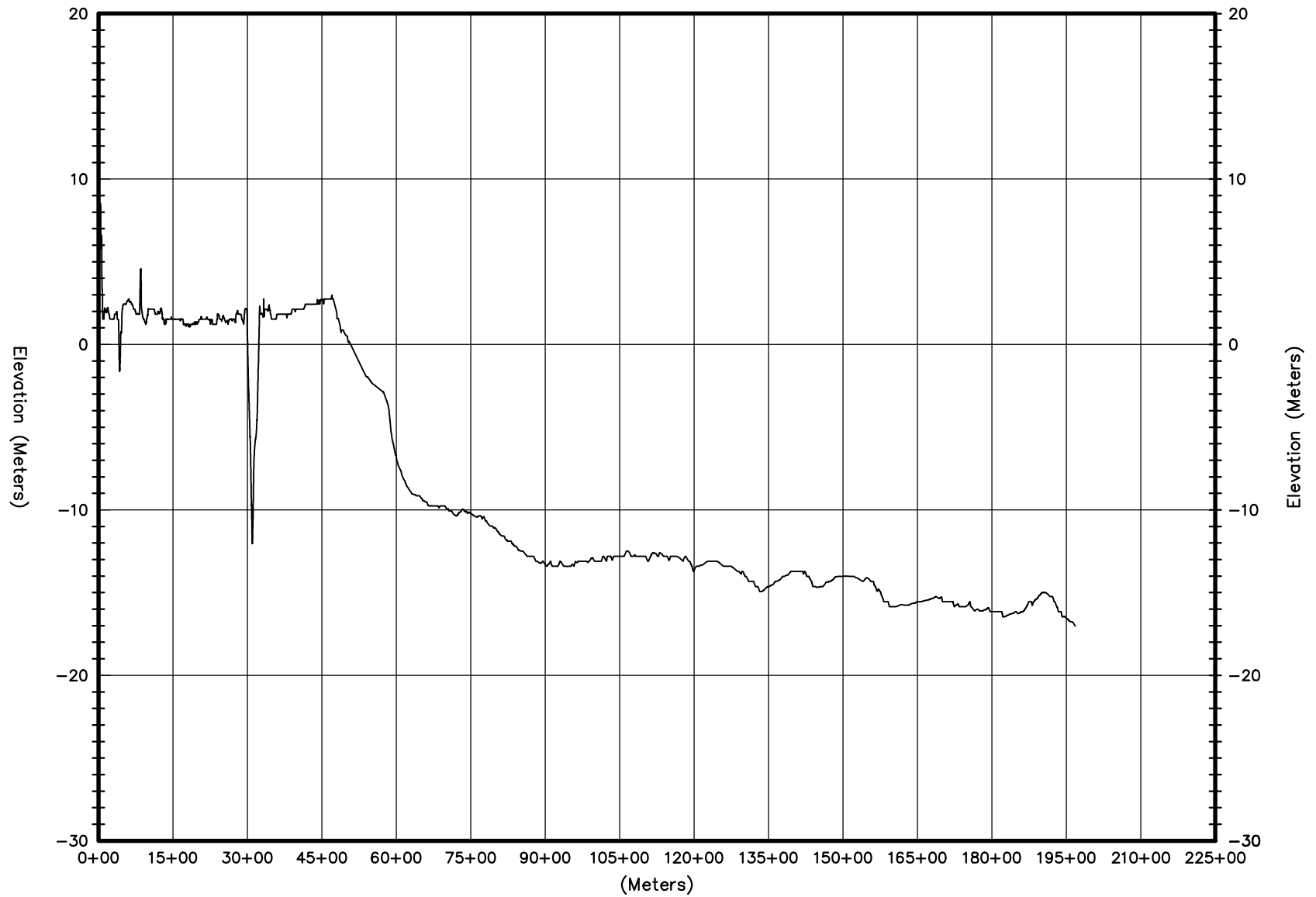

WWW.TETRATECH.COM
10 POST OFFICE SQUARE, 11TH FLOOR
BOSTON, MA 02109
Phone: (617) 443-7500 Fax: (617) 737-3480

NO	REVISION	DATE
1	ISSUE FOR ARTICLE VII	5/19/22
1	ISSUE FOR ARTICLE VII	6/30/23

EMPIRE OFFSHORE WIND LLC
EMPIRE WIND 2 - EXPORT CABLES
EXAGGERATED PROFILE

PROJ: 194-1247-0001

DESIGN: R. GIFFORD

PAGE 1 OF 1

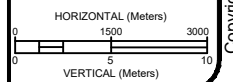

Bar Measures 1 inch